



POWERSPORTS

JL50QT-14

ASSEMBLY INSTRUCTIONS



PLEASE NOTE THAT THIS IS NOT THE OWNER'S MANUAL BUT THE ASSEMBLY INSTRUCTIONS ONLY.

BEFORE OPERATING THIS SCOOTER, MAKE SURE THE OPERATOR HAS READ AND UNDERSTANDS THE OWNER'S MANUAL, WARNING LABELS AND IS FAMILIAR WITH ALL OF THE SCOOTER CONTROLS.

FOR QUESTIONS REGARDING THE ASSEMBLY OF THIS SCOOTER PLEASE CALL COLEMAN POWERSPORTS 888-405-8725

Main stand INSTALLATION

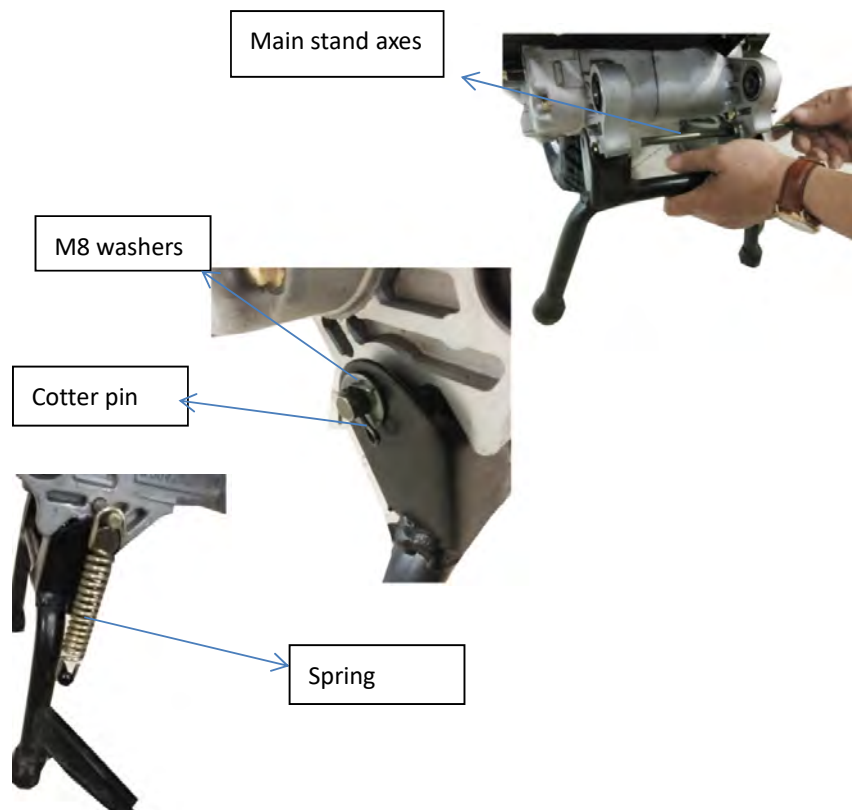
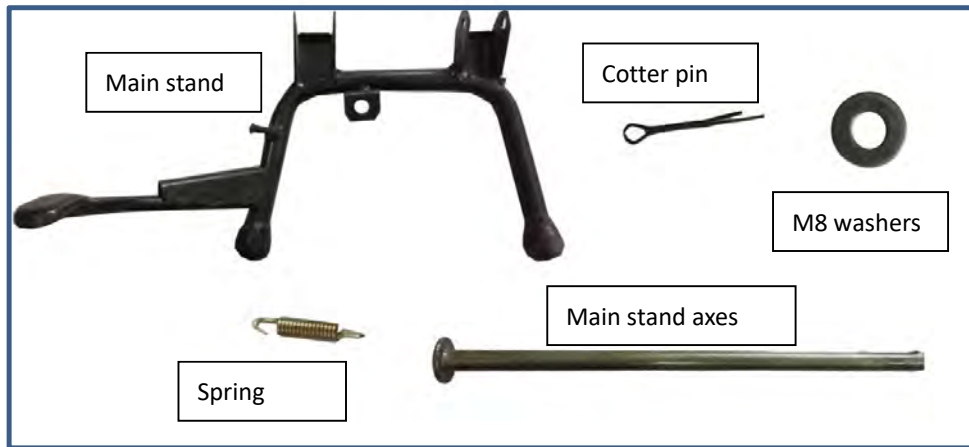

1. Put main stand in engine holder, then insert the axes to the bottom.
2. Put M8 washer at the other side of axes, insert cotter pin to the hole, then bend it.
3. Connect the main stand and engine by spring.

Front wheel INSTALLATION

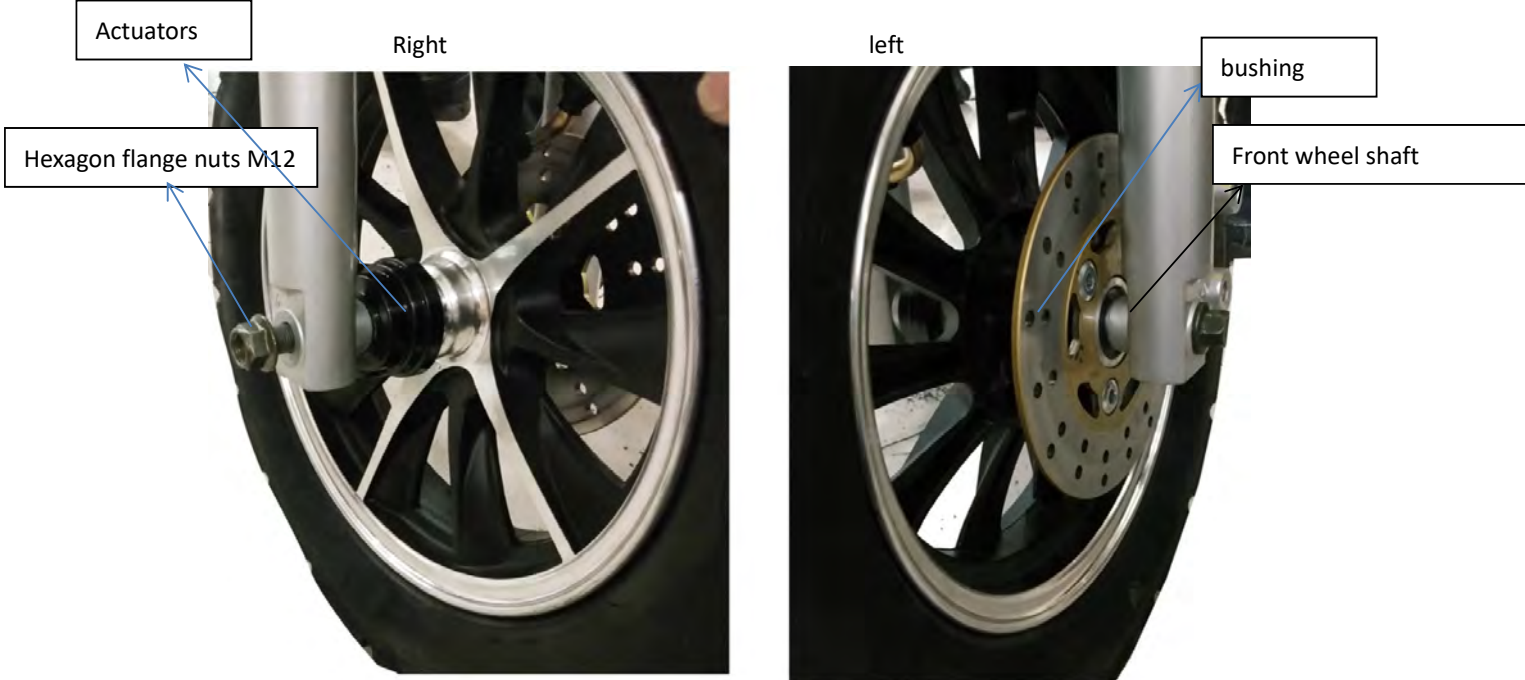
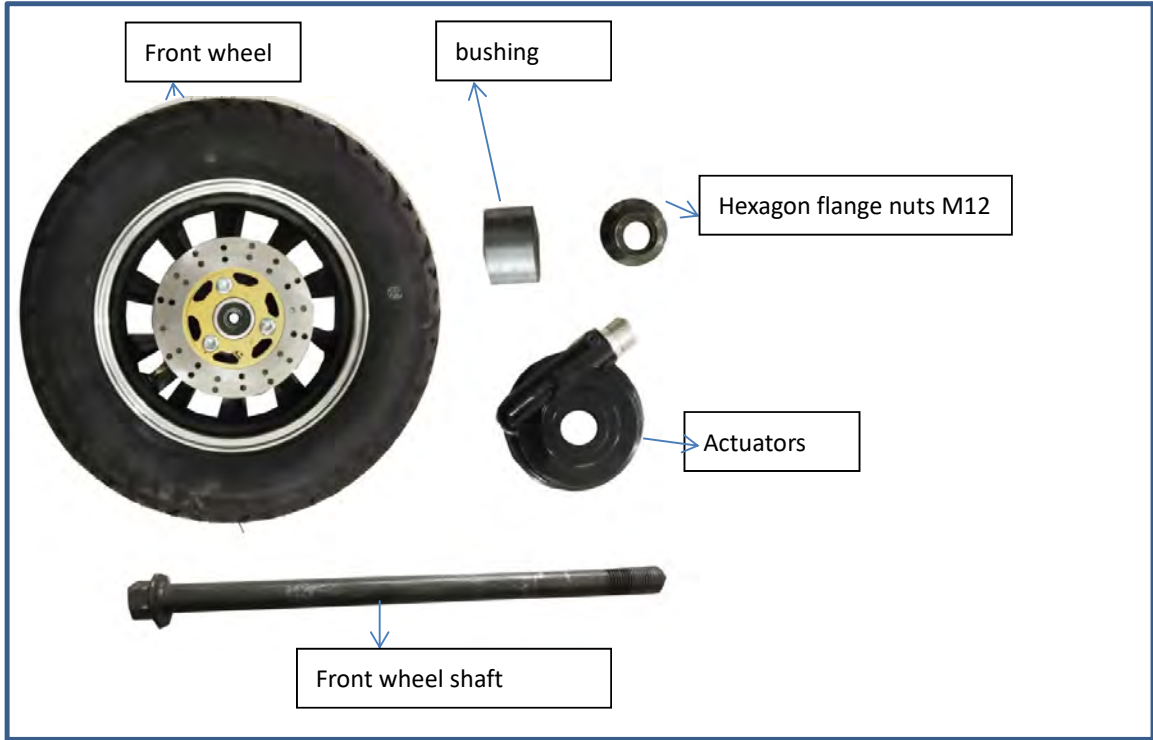

1. Put the front wheel into the front shock absorber, put the actuators on the left and the bushing on the right.
2. Use the front wheel shaft from the making side to the right side, and tighten with the nut. Fastening moment 30-40n.m

HANDLE BAR INSTALLATION

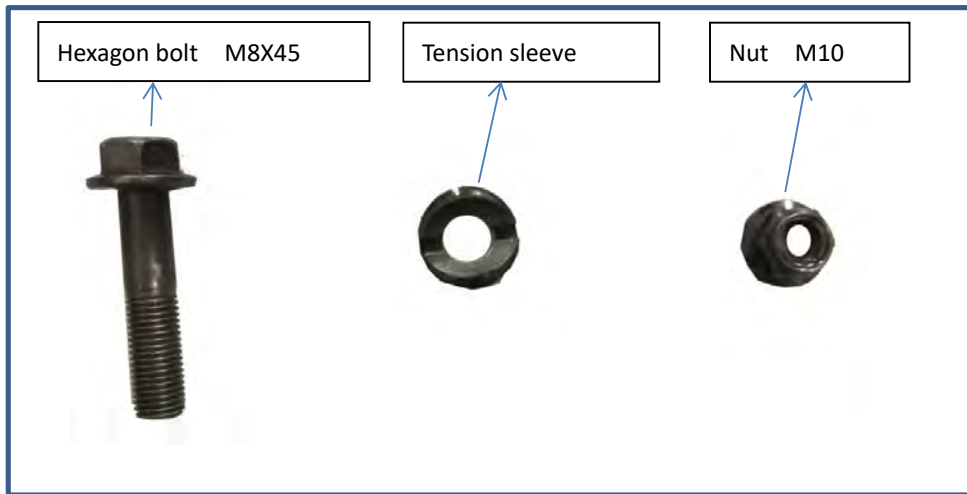

FRONT

BACK



1. Put the handle bar into the front fork, insert the bolt and the tightening sleeve, successively from the front to the back, then tighten with the nut.
2. Tightening torque: 30-40n.m

Front cover INSTALLATION

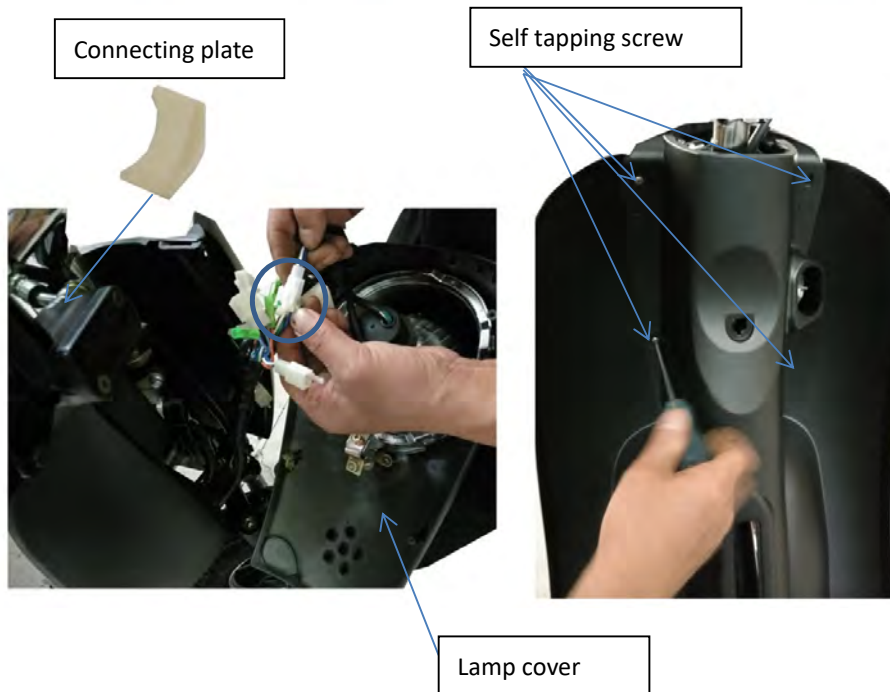

1. Install the connecting plate in the front tool box recess.
- 2 Connect the headlamp cable socket to the main cable socket, then install the front cover in the toolbox.
3. On the back of the toolbox, tighten with four ST4.2x12 self-tapping screws.

Front fender INSTALLATION

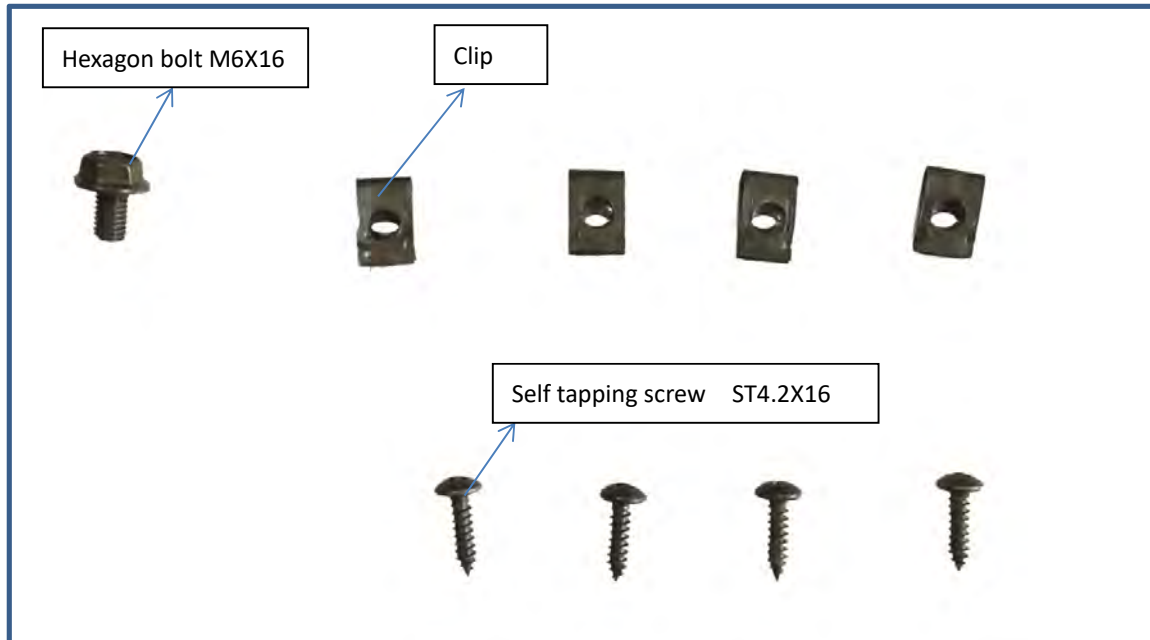

1. Insert 4 clips into the back of the front fender.
2. Put the front fender on the front fork and connect it to the back of the front fender. Fasten it with one M6X16 bolt and four st4.2x16 self-tapping screws respectively.

BATTERY INSTALLATION

WARNING

If sulfuric acid is swallowed or splashed in the eyes, treat immediately. Sulfuric acid in the eyes can cause blindness. Serious internal injuries or death can result if swallowed.

ANTIDOTES: For acid on the skin, flush with water.

If acid is swallowed drink large quantities of milk or water, followed by milk of magnesia, vegetable oil or beaten eggs. Do not induce vomiting. Call a poison control center or doctor immediately. For acid in the eyes, flush for several minutes with water and seek immediate medical attention.

Make sure work area is well ventilated.

Always wear goggles or face shield when working with the battery.

Always wear protective plastic gloves to protect hands

Always wear a protective smock to protect clothing.

Battery electrolyte (Sulfuric Acid) is poisonous , electrolyte can cause severe burns if contacts skin. Avoid contact with skin, eyes or clothing.

Battery preparation

1. Remove battery (1) and electrolyte bottle (2) from box. Remove battery cap strip (3) from electrolyte bottle

2. Pull tape strip (4) off top of battery and discard.

3. Turn electrolyte bottle over and place on top of battery pushing firmly until the battery nozzle tips puncture the film over the spouts. Allow all electrolyte to flow into the battery.

Note: Dispose of electrolyte bottle properly

4. Install battery cap strip (3). Let battery sit for 1/2 hour before charging.

Note: The battery is a sealed type battery once the cap is in place.

There is no maintenance to fluid level. Never re-open once caps are in place.

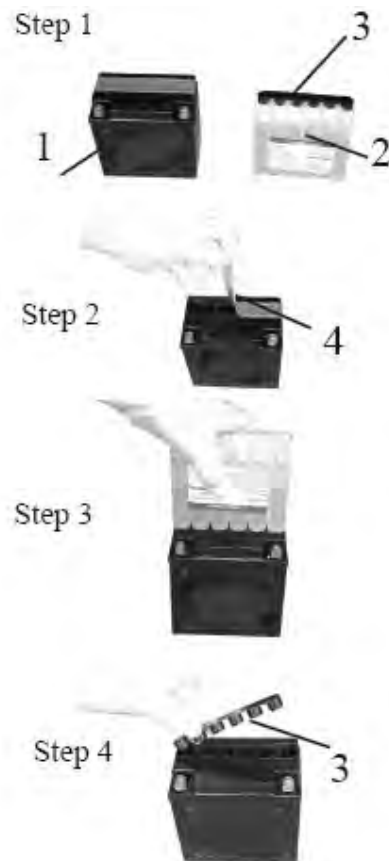

Charging the battery

Note: Do not turn the charger on before attaching the charger clips to the battery terminals.

The standard charging rate is 0.7A x 5 -10 hours. Maximum charging rate is 3A x 1hour

1. Attach the Charger to the battery terminals. Red clip to the POS + side of the battery. Black clip to the NEG - side of the battery.
2. Plug in the charger and turn on making sure it is set at the correct settings.
3. Once battery is charged, unplug the charger before disconnecting the POS + and NEG- clips



WARNING

If not performed the correct way, charging the battery could be hazardous.

While charging battery, keep away from sparks and open flames. The battery gives off explosive gasses. Always connect the charger to the battery before turning the charger on, this will prevent sparks when attaching the terminal clips to the battery.

Always unplug the charger before disconnecting the battery from the charger, this will prevent sparks when removing the terminal clips

CAUTION

Reversing the battery lead wires can damage the charging system and the battery.

The red lead (clip) must go to the POS (+) side of the battery. The black lead (clip) must go to the NEG (-) side of the battery.

Installing the battery

1. Install battery in battery bracket located under left rear fender of ATV.
2. Attach the red wire to the POS + side of the battery with screws provided. Attach the black wire to the NEG - side of the battery with screws provided. Make sure the connections are tight.
3. Install the rubber strap to hold the battery in place.

WARNING

THIS IS NOT THE OWNER'S MANUAL, THIS IS THE ASSEMBLY INSTRUCTIONS ONLY.

THE OWNER'S MANUAL, INCLUDED WITH THIS SCOOTER, HAS ALL INFORMATION REQUIRED FOR SAFETY, ENGINE PREPARATION, PRE-RIDE INSPECTION AND STARTING INSTRUCTIONS.

NEVER START THE ENGINE WITHOUT READING AND FULLY UNDERSTANDING THE OWNER'S MANUAL AND ALL WARNINGS.

IF YOU DID NOT GET AN OWNER'S MANUAL WITH THIS SCOOTER, PLEASE CALL COLEMAN POWERSPORTS AT 888-405-8725.