



POWERSPORTS

## CAUTION

THIS GO KART WAS SHIPPED WITHOUT ENGINE OIL. ALWAYS FILL WITH THE CORRECT AMOUNT AND GRADE OF ENGINE OIL AS LISTED IN THE OWNER'S MANUAL

# ASSEMBLY/PRE-RIDE INSPECTION INSTRUCTIONS

**CK196-T**  
**CK196-M**

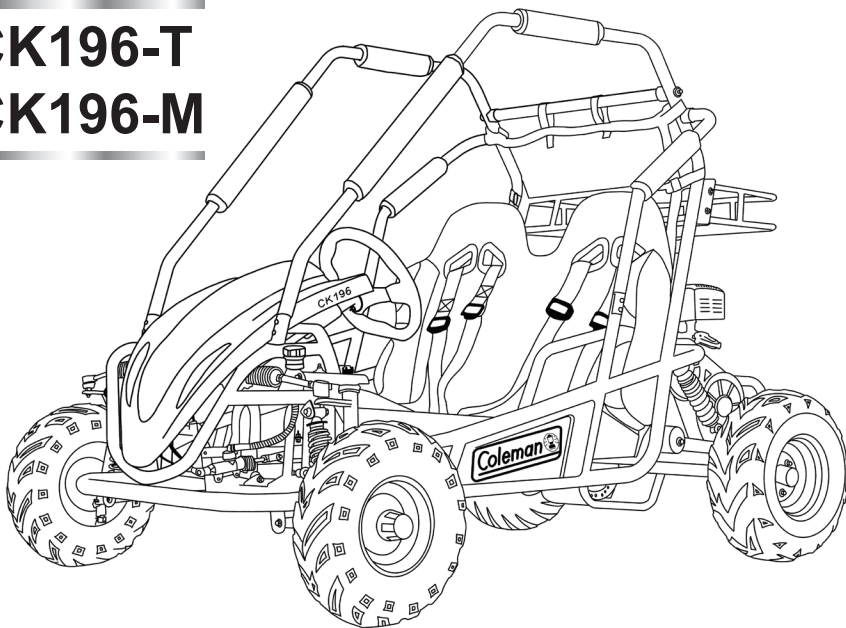

FOR QUESTIONS ABOUT THESE ASSEMBLY INSTRUCTIONS,  
CALL COLEMAN POWERSPORTS 888-405-8725



## WARNING

NEVER ATTEMPT TO START THIS GO KART WITHOUT READING AND UNDERSTANDING THE OWNER'S/ OPERATOR'S MANUAL. THE OWNER'S OPERATOR'S MANUAL PROVIDES INFORMATION ON SAFETY, PARTS, FUNCTIONS, PRE-RIDE INSPECTION, STARTING AND MAINTENANCE

# REMOVAL FROM CRATE

1. Remove metal crate from around Go-Kart.

2. Locate and Remove Owner's/Operator's manual, Set up instructions and all documentation.

Note:

Read Owner's / Operator's manual thoroughly before starting Go-Kart for the first time.

3. Locate and remove all parts and hardware from crate and set aside.

Note: Some hardware may already be mounted at part locations on the Go-Kart. This hardware will need to be removed then re-attached during assembly.

## REAR RACK

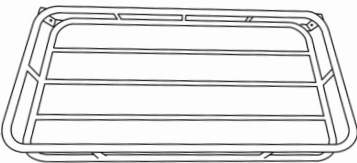

## WHEEL PARTS

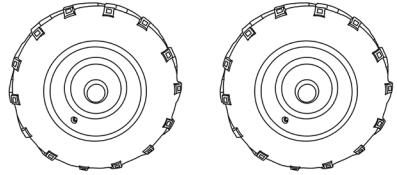

Rear Tires

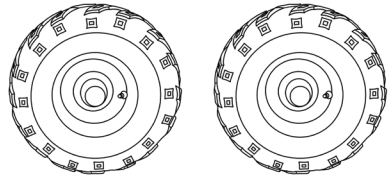

Front Tires



Rubber Hub Caps

## STEERING WHEEL

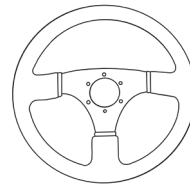

Steering Wheel



Steering Wheel Cap

---

## Brush Guard Parts



Main Brush Guard



Brush Guard Side Support



Brush Guard Cross Braces

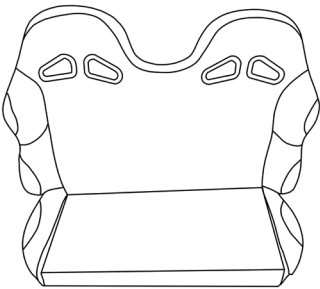

Seat

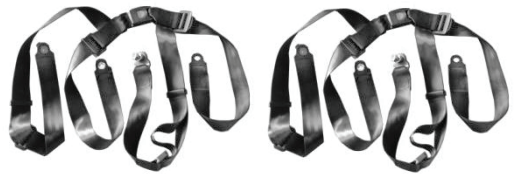

Safety Belt



Safety Net

# REAR WHEEL ASSEMBLY

## HARDWARE

- M20 Washer.....2ea. (3)
- M20 Castle Nut.....2ea. (2)
- Cotter Pin.....2ea. (4)
- Gasket 20.....2ea. (1)

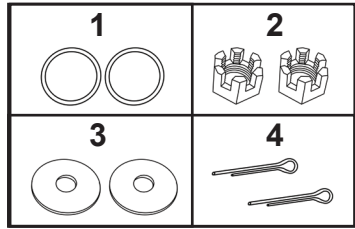

- 1.) Lift the Go Kart with a jack.
- 2.) Install rear tires with Gasket 20 (1), M20 Washer (3), Cotter Pin (3), and M20 Castle Nut (2).

NOTE: Make sure tire tread faces forward and air valve stem is on the outside of the tire when installing.

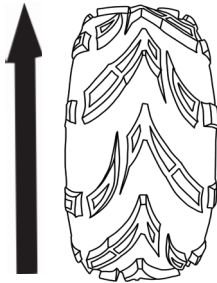
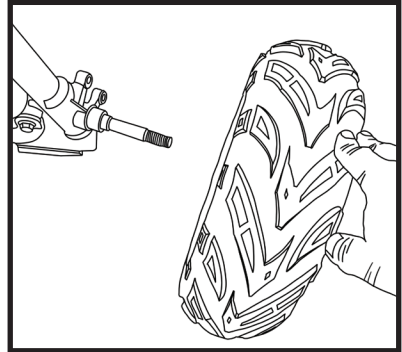

- 3.) Install Hub Caps (5) by snapping on each hub.

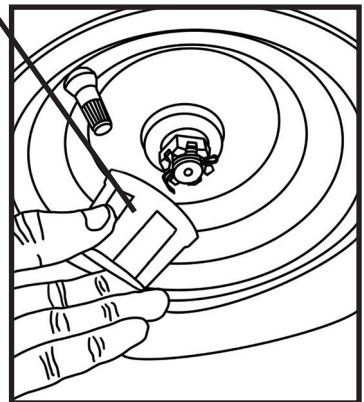
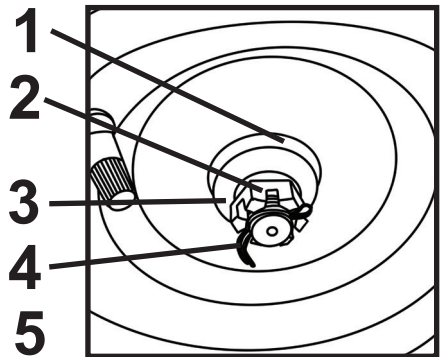

## WARNING

Failing to install cotter pins could be hazardous.  
Failing to install cotter pins could cause the castle nuts to fall off resulting in an accident.  
Never operate Go Kart without cotter pins installed.

# FRONT WHEEL ASSEMBLY

## HARDWARE

- M14 Washer.....2ea. (3)
- M14 Castle Nut.....2ea. (2)
- Cotter Pin.....2ea. (4)
- Gasket 14.....2ea. (1)

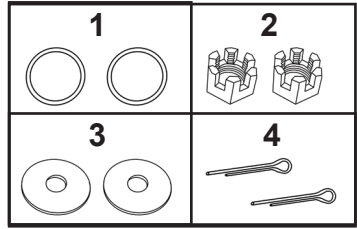

- 1.) Lift the Go Kart with a jack.
- 2.) Install rear tires with Gasket 14 (1), M14 Washer (3), Cotter Pin (4), and M14 Castle Nut (2).

NOTE: Make sure tire tread faces forward and air valve stem is on the outside of the tire when installing.

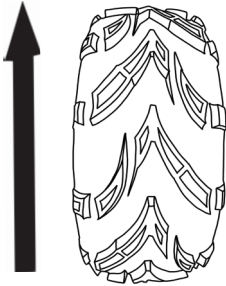

- 3.) Install Hub Caps (5) by snapping on each hub.

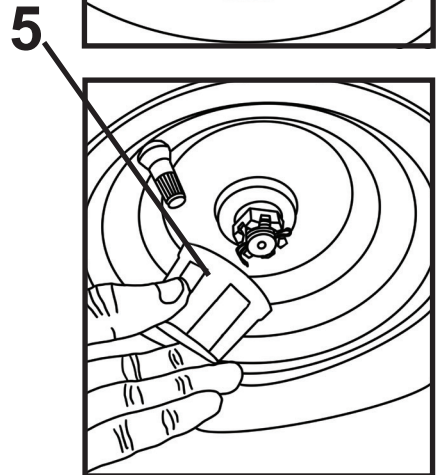
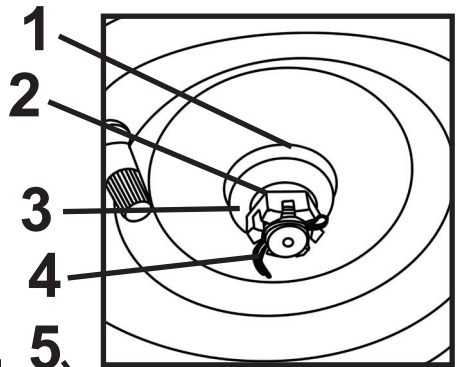
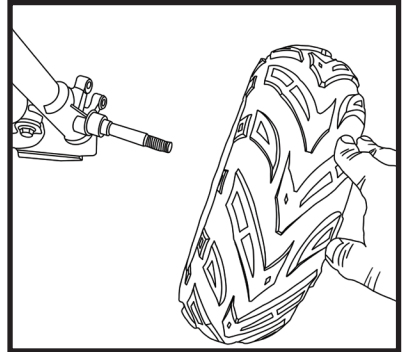

**⚠ WARNING**

Failing to install cotter pins could be hazardous.  
Failing to install cotter pins could cause the castle nuts to fall off resulting in an accident.  
Never operate Go Kart without cotter pins installed.

# STEERING WHEEL INSTALLATION

Hardware:

M6X16 Bolts 3ea.(1)

M6 Nuts 3ea.(2)

1



2

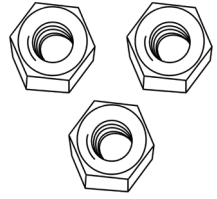

1、 Attach steering wheel using M6 bolts (1) and M6 nuts (2).

2、 Attach steering wheel cap by snapping into place on center of steering wheel.

Steering Wheel Cap

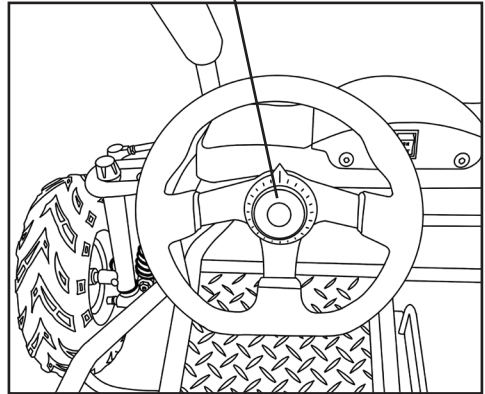
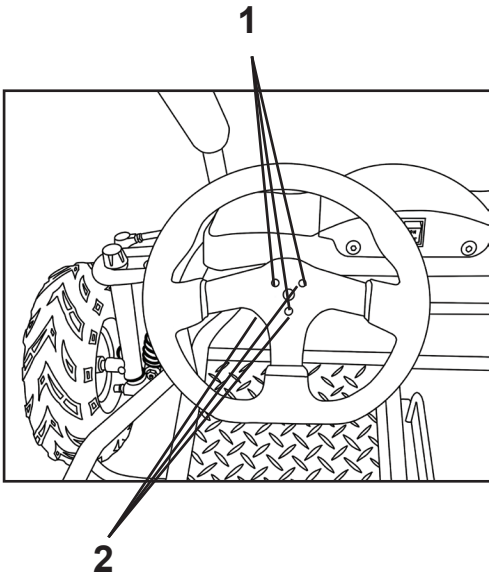

# SEAT INSTALLATION

Hardware:

M8 x 35 bolts 2 ea. (1)

M8 Nuts 2 ea. (2)

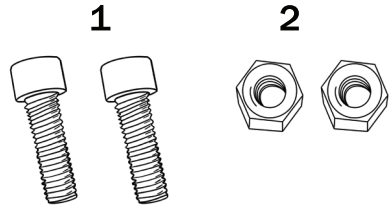

1. Install the seat with M8x35 bolts (1) and M8 Nuts (2).

Note: When install the seat, attach the barb on the seat slide before install the bolt.

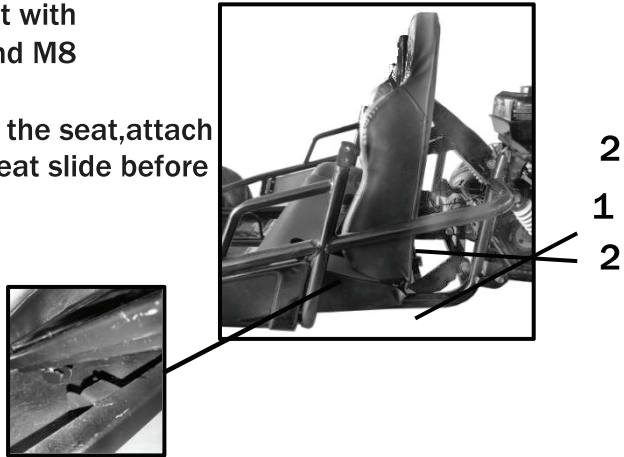

## SAFETY BELT INSTALLATION

1. Install the self belt on the frame with bolt, washer, nut and Gasket.

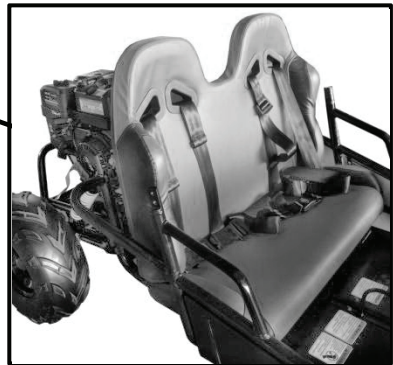

Low install point through the seat

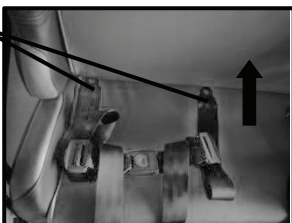

# BRUSH GUARD INSTALLATION

## Hardware:

M8 X 50 bolts 4 ea. (1)

M8 X 20 bolts 12ea. (2)

M8 Concave Washers 4 ea. (3)

1

2

3



1. Attach Main Brush Guard with M8x20 bolts.

Note: Do not tighten bolts at this time, keep bolts loose until the brush guard is completely assembled.

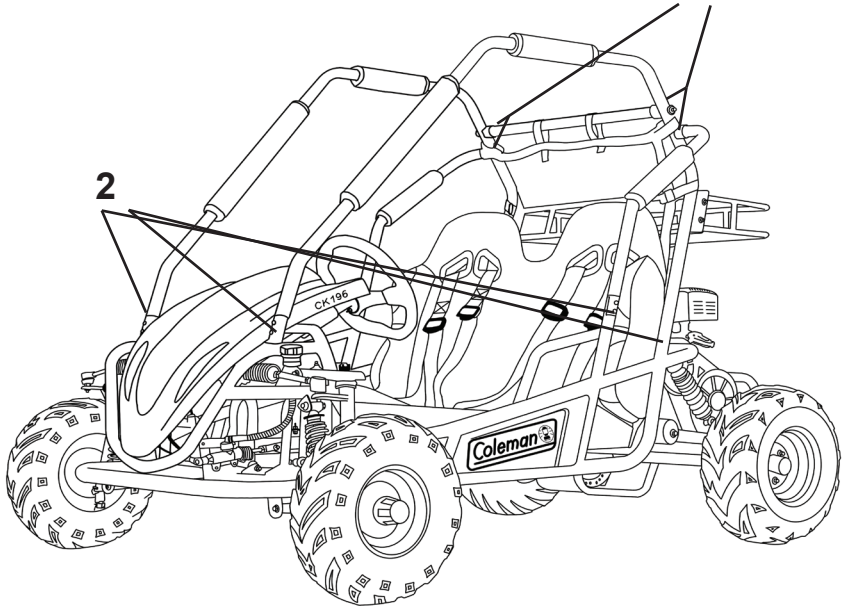
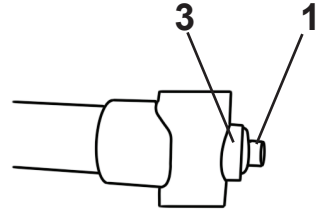

2. Attach center and side supports with M8 Concave Washers (3) and M8x50 Bolts (1).

3. Tighten all bolts on rack and Brush Guard assembly



# REAR SAFETY NET

---

1. Attach safety net on brushguard.

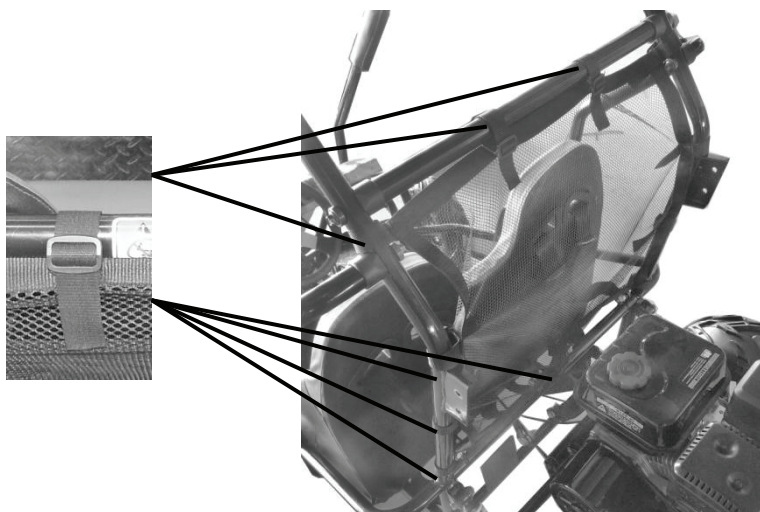

# REAR RACK INSTALLATION

Hardware:

M8x16 bolts 4 ea.(1)

M8 nuts 4 ea. (2)

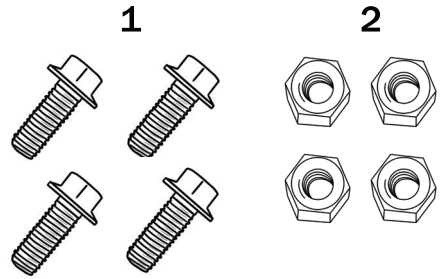

Assemble the rear rack to the roll mounting point with Flange bolt M8x16(1)and nut M8.

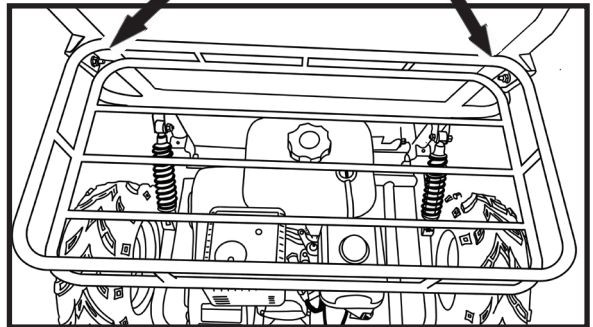
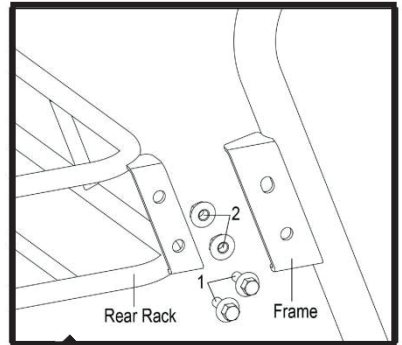

# PRE-RIDE INSPECTION

Inspecting and checking the condition of the Go Kart before each ride is important. Following the pre-ride check list will help insure the you do not have mechanical problems which could result in injury or becoming stranded. Make sure the Go Kart is in good operating condition before each ride.

**⚠ WARNING**

Failing to inspect and maintain your Go Kart could be hazardous.

Not following the pre-ride inspection procedures could result in losing control of the Go Kart resulting in an accident or damage to the Go Kart

Always perform a Pre-ride inspection before each ride.

**⚠ WARNING**

Performing maintenance and checks while the engine is running could be hazardous.

You could be severely injured by moving parts or hot surfaces.

Never perform maintenance or check procedures while the engine is running with the exception of checking the ignition switch or throttle.

WHAT TO CHECK	CHECK FOR
Steering	<ul style="list-style-type: none"> <li>• Smoothness</li> <li>• No restriction of movement</li> </ul>
Brakes	<ul style="list-style-type: none"> <li>• Correct fluid level</li> <li>• Inspect hoses for leaks</li> <li>• Inspect brake pads for wear.</li> </ul>
Tires	<ul style="list-style-type: none"> <li>• Proper tire pressure</li> <li>• Proper tread depth</li> <li>• Rubber has no cracks</li> </ul>
Fuel Tank	<ul style="list-style-type: none"> <li>• Enough fuel for the ride</li> <li>• Fuel cap secure</li> <li>• Hoses have no signs of cracks or leaks</li> </ul>
Throttle Pedal	<ul style="list-style-type: none"> <li>• Pedal snaps back to idle when released</li> <li>• Operates freely</li> </ul>
Engine Ignition switch	<ul style="list-style-type: none"> <li>• Switch shuts off engine when activated.</li> </ul>
Engine Oil	<ul style="list-style-type: none"> <li>• Correct oil level</li> </ul>
Torque Converter Guard	<ul style="list-style-type: none"> <li>• No damage</li> <li>• Securely attached</li> </ul>
Drive Chain	<ul style="list-style-type: none"> <li>• Proper tension</li> <li>• Lubricated</li> <li>• No excessive wear or damage</li> </ul>
General Condition	<ul style="list-style-type: none"> <li>• All nuts and bolts tight</li> <li>• No rattles from engine or frame while running</li> </ul>



## **WARNING**

NEVER ATTEMPT TO START THIS GO KART WITHOUT READING AND UNDERSTANDING THE OWNER'S/ OPERATOR'S MANUAL. THE OWNER'S/ OPERATOR'S MANUAL PROVIDES INFORMATION PROVIDES INFORMATION ON SAFETY, PARTS, FUNCTIONS, PRE-RIDE INSPECTION, STARTING AND MAINTENANCE



# POWERSPORTS

**(888) 405-8725**

**1775 E. University Dr., Tempe, AZ 85281**

**[www.colemanpowersportsusa.com](http://www.colemanpowersportsusa.com)**

---

[www.facebook.com/colemanpowersportusa.com](http://www.facebook.com/colemanpowersportusa.com)

[www.instagram.com/colemanpowersports\\_usa](http://www.instagram.com/colemanpowersports_usa)

